

# EC-M-VA

Technical data

OCS Checkweighers GmbH  
Adam-Hoffmann-Straße 26  
67657 Kaiserslautern  
Germany  
[www.ocs-cw.com](http://www.ocs-cw.com)  
[info.ww@ocs-cw.com](mailto:info.ww@ocs-cw.com)



08406101 CFCK 15

All rights reserved.

A Wipotec Brand



The Type EC-M-VA checkweigher is intended for industrial use in light to medium damp room environments with the corresponding cleaning requirements. It is of a completely stainless steel design and optimally fulfills the relevant hygiene requirements for applications of this type. A large selection of options and a specially tailored handling system allow a flexible system configuration for the specific application. The EC-M-VA offers the same comprehensive functions as the EC-M with regard to open-loop and closed-loop control technology.

## **Weighing principle**

The precision Weigh Cell works on the principle of Electro Magnetic Force Restoration (EMFR); manual or automatic measuring time recording; weighing cell stainless steel with secondary hood.

## **Conveyor technology**

Full stainless steel belt design with folding shaft (side bars technology); toolfree belt changing; stainless steel ball bearing, specially coated and encapsulated ATC bearing (optional); full stainless steel folding belt as sorting unit (optional)

## **Frame**

Stainless steel base frame in a stable tubular frame design, cross-braces made of solid material to increase stability and the integration weight

## **Display and operation**

5.7 inch graphic monitor (LCD) with touch screen, black and white

## **Available dialog languages**

4 (German, English, French as standard and also a free selection from: Danish, Dutch, Italian, Croatian, Polish, Portuguese, Russian or Spanish, other languages on request)

## **Product parameter memory**

50 PLU as standard; can be optionally extended to 80 PLU's

## **Motors**

4 (infeed belt, precision weighing belt, discharge belt, 1 additional motor); motors encapsulated in special stainless steel casings

## **Emergency operation**

Integrated emergency operation function with hardware switch and message on screen

## **Separation**

1 blower nozzle or pusher (optionally) included in the basic machine configuration. Compressed air service unit and control valves encapsulated in their own stainless steel casing; a wide and fully-developed range of sorting units such as folding belts, sorting gates etc. (optional).

## **Interface**

Optionally: RS 232c, RS 422, RS 485, TTY (current loop)

The accompanying brochure EC-M gives an overview of all available options.

# EC-M-VA

Damp room version

OCS Checkweighers GmbH  
Adam-Hoffmann-Straße 26  
67657 Kaiserslautern  
Germany  
www.ocs-cw.com  
info.ww@ocs-cw.com



<b>EC-M-VA</b>	<b>GWR</b> (gross weighing range)	<b>max. DL</b> (max. deadload)	<b>e ≥</b> (min. calibration value)	<b>n</b> (graduation steps)
<b>3000-3</b>	1500 g	8500 g	0.2 g	7500
<b>3000-2</b>	3750 g	8500 g	0.5 g	7500
<b>3000-1</b>	7500 g	8500 g	1.0 g	7500
<b>4000-2</b>	7500 g	15000 g	1.0 g	7500

<b>Maximum output<sup>1)</sup></b>	230 units per min.
<b>Temperature range</b>	+5° C to +40° C
<b>Type approval</b>	10.49/96.01 (Germany) OIML Certificate No. R51/1996-DE-97.02
<b>Electrical connection</b> Nominal voltage Nominal frequency Connected load	L1/N/PE 230 V/115 V 50/60 Hz approx. 0.8 kVA
<b>Compressed air supply</b>	6 bar approx. 10 NI/min Quality class 1/4/1 in acc. with DIN ISO 8573-1
<b>Weight</b> Intrinsic weight Dispatch weight	approx. 110 kg (standard machine) approx. 170 kg
<b>Protection type<sup>2)</sup></b>	General protection type IP 65 (damp room version, wet cleaning)
<b>Standard deviation (1s)<sup>1)</sup></b>	from 100 mg

<sup>1)</sup> Depending on the product shape, product behaviour, transport speed and ambient conditions.

<sup>2)</sup> We recommend an application-related test of the required protection type.

# EC-M-VA

Damp room version



CHECKWEIGHERS

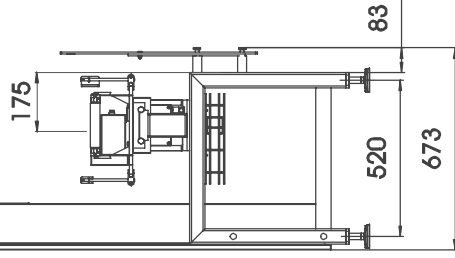
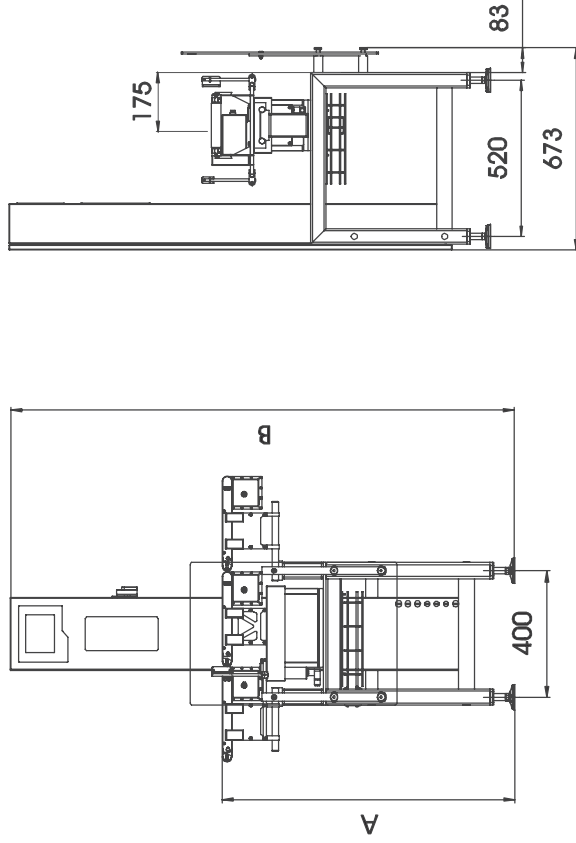

## Dimensions:

### Valid for all EC-M-VA checkweighers

A = Working height	700-850 / 800-950 / 900-1050
B = Total height	approx. 1580 (+ 150 mm when the max. foot height is used)
C = Conveyor width Roller diameter VA30WA	120 / 150 / 200 / 300
D = Infeed and discharge belt	250 / 300 / 400 / 500
E = Weighing belt	250 / 300 / 400
F = Discharge and infeed belt	250 / 300 / 400 / 500
G = Total length	D + E + F + approx. 15 mm

## Weight values:

### Valid for VA30WA weighing belts

Width	Length	250	300	400
120		5.200 g	5.500 g	6.300 g
150		5.700 g	6.000 g	6.600 g
200		6.300 g	6.700 g	7.300 g
300		<sup>3)</sup>	<sup>3)</sup>	8.800 g

<sup>3)</sup> = optionally strap conveyor

All measurements in mm. The stated weights are approximate values. These measurements are guideline values for the standard machine without application-specific and weighing-specific attachment parts (e.g. side guide etc.)

